



## THULE CHARIOT SPORT 2 SINGLE 10201030 | 10201032



### Thule Chariot Sport 2 single

Made to make training safe, easy and fun, Thule Chariot Sport 2 lets you experience easy transitions between cycling, strolling, and running. A quick, one-handed 180-degree wheel rotation turns the bike trailer into a stroller in seconds.

- 4 activities – designed to excel when you bike, jog, stroll, and ski (Jogging and Ski Kits sold separately). The included rain cover and sun canopy keep your child dry and shields them from the sun
- Integrated LED light for better visibility in all conditions and a more stylish design
- Hand activated disc brakes for increased control on steeper terrain and while running
- Convenient one-hand recline and fully padded seat for on the go naps
- The redesigned FlipWing-system allows for even easier switching between biking and strolling and back, now with the possibility to flip the wheels up and down while the trailer is attached to the bike
- The new hitch arm allows the user to easily and securely attach and detach the trailer to the bike using only one hand
- Adjustable suspension to allow you to customise the comfort of the ride as your child grows or if you transport heavier items in the trailer
- Large cargo basket with zipper for more secure storage of items, that can be stored away for increased kick stride while jogging
- Compact, easy to operate folding mechanism makes it easier than ever to bring the carrier with you
- Climate controlled interior with removable windows and multi-adjustable sun visor. Vents ensure optimal airflow and climate control, removable clamps provide more ventilation when using a rain cover
- Thule Click n' Store makes for convenient on-board storage of strolling, jogging, and cycling kit while in different activity mode
- Comfortable padded seats are removable and easy to clean



#### MODEL NUMBER

10201030

10201032

#### AVAILABLE

June 2024

#### UPC / EAN CODE

197074564733

197074564757

#### REPLACES

10201013, 10201014

#### COLOR

Black

Natural Gold

#### CATEGORY

Baby & kids

#### FOLDED PRODUCT DIMENSIONS (L x W x H)

86.3 x 63.3 x 37.5 cm / 34 x 25 x 14.8 in

#### UNFOLDED PRODUCT DIMENSIONS (L x W x H)

94.8 x 65.5 x 87 cm / 37.3 x 25.8 x 34.3 in

#### PACKAGING DIMENSIONS (L x W x H)

87.9 x 37.5 x 64 cm / 34.6 x 14.8 x 25.2 in

#### PACKAGING TYPE

Cardboard

#### MATERIALS

Aluminum frame, steel and nylon parts and polyester cover

#### MASTER CARTON QTY

1

#### MASTER CARTON WEIGHT

21.5 kg / 47.4 lbs

#### MASTER CARTON DIMENSIONS (L x W x H)

87.9 x 37.5 x 64 cm / 34.6 x 14.8 x 25.2 in

#### CONTENTS

Thule Chariot Sport 2, Bicycle trailer kit, Strolling kit, Ventilation clips

#### COUNTRY OF ORIGIN

China

#### WARRANTY

See Thule.com



#### AVAILABLE ACCESSORIES

- Thule Chariot 2 jogging kit, 20201303
- Thule Chariot 2 cross-country skiing kit, 20201402
- Thule Chariot Infant Sling, 20201531
- Thule baby supporter, 20201518
- Thule Chariot floor mat, 20201522
- Thule Chariot brake kit, 20201410
- Thule bottle cage, 20201521
- Thule Chariot seat liner, 20201519
- Thule cargo rack, 20201513
- Thule organizer, 20201520
- Thule Chariot travel bag, 20201524
- Thule Delight 2, 20201529
- Thule power bank 10k, 20201527
- Thule footmuff sport, 20101003
- Thule Chariot storage cover, 20100784
- Thule axle mount ezHitch™ plate with quick release skewer, 20201525

Estimated weight and dimensions.

\* Weight without conversion kit.



## THULE CHARIOT SPORT 2 DOUBLE 10201031 | 10201033

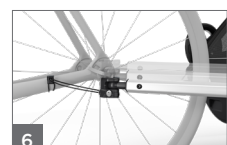

### Thule Chariot Sport 2 Double

Made to make training safe, easy and fun, Thule Chariot Sport 2 double lets you experience easy transitions between cycling, strolling, and running. A quick, one-handed 180-degree wheel rotation turns the bike trailer into a stroller in seconds.

- 4 activities – designed to excel when you bike, jog, stroll, and ski (Jogging and Ski Kits sold separately). The included rain cover and sun canopy keep your child dry and shields them from the sun
- Integrated LED light for better visibility in all conditions and a more stylish design
- Hand activated disc brakes for increased control on steeper terrain and while running
- The modular seating ability means that you can choose to have one kid sitting in the middle, or two kids on either side of the trailer. Convenient one-hand recline and fully padded seats for on the go naps
- The redesigned FlipWing-system allows for even easier switching between biking and strolling and back, now with the possibility to flip the wheels up and down while the trailer is attached to the bike
- The new hitch arm allows the user to easily and securely attach and detach the trailer to the bike using only one hand
- Adjustable suspension to allow you to customise the comfort of the ride as your child grows or if you transport heavier items in the trailer
- Large cargo basket with zipper for more secure storage of items, that can be stored away for increased kick stride while jogging
- Compact, easy to operate folding mechanism makes it easier than ever to bring the carrier with you
- Climate controlled interior with removable windows and multi-adjustable sun visor. Vents ensure optimal airflow and climate control, removable clamps provide more ventilation when using a rain cover
- Thule Click n' Store makes for convenient on-board storage of strolling, jogging, and cycling kit while in different activity mode
- Comfortable padded seats are removable and easy to clean



2

<b>MODEL NUMBER</b> 10201031 10201033	<b>UPC / EAN CODE</b> 197074564740 197074564764	<b>COLOR</b> Black Natural Gold
<b>AVAILABLE</b> June 2024	<b>REPLACES</b> 10201023, 10201024	<b>CATEGORY</b> Baby & kids
<b>FOLDED PRODUCT DIMS (L x W x H)</b> 86.3 x 77.3 x 37.5 cm / 34 x 30.4 x 14.8 in		<b>PRODUCT WEIGHT</b> 20.3 kg / 44.8 lbs *
<b>UNFOLDED PRODUCT DIMS (L x W x H)</b> 94.8 x 79.8 x 87 cm / 37.3 x 31.4 x 34.3 in		<b>PACKAGING WEIGHT</b> 23.6 kg / 52 lbs
<b>PACKAGING DIMS (L x W x H)</b> 87.4 x 77.4 x 37.7 cm / 34.4 x 30.5 x 14.8 in		
<b>PACKAGING TYPE</b> Cardboard	<b>MATERIALS</b> Aluminum frame, steel and nylon parts and polyester cover	
<b>MASTER CARTON QTY</b> 1	<b>MASTER CARTON WEIGHT</b> 23.6 kg / 52 lbs	
<b>MASTER CARTON DIMS (L x W x H)</b> 87.4 x 77.4 x 37.7 cm / 34.4 x 30.5 x 14.8 in		
<b>CONTENTS</b> Thule Chariot Sport 2 Double, Bicycle trailer kit, Strolling kit, Ventilation clips		
<b>COUNTRY OF ORIGIN</b> China		<b>WARRANTY</b> See Thule.com
<b>AVAILABLE ACCESSORIES</b> Thule Chariot 2 jogging kit, 20201304 Thule Chariot 2 cross-country skiing kit, 20201402 Thule Chariot Infant Sling, 20201531 Thule baby supporter, 20201518 Thule Chariot floor mat, 20201523 Thule Chariot brake kit, 20201410 Thule bottle cage, 20201521 Thule Chariot seat liner, 20201519 Thule cargo rack, 20201513 Thule organizer, 20201520 Thule Chariot travel bag, 20201524 Thule Delight 2, 20201529 Thule power bank 10k, 20201527 Thule footmuff sport, 20101003 Thule Chariot storage cover, 20100784 Thule axle mount ezHitch™ plate with quick release skewer, 20201525		



Estimated weight and dimensions.  
\* Weight without conversion kit.